

Step 01- Install the Servo

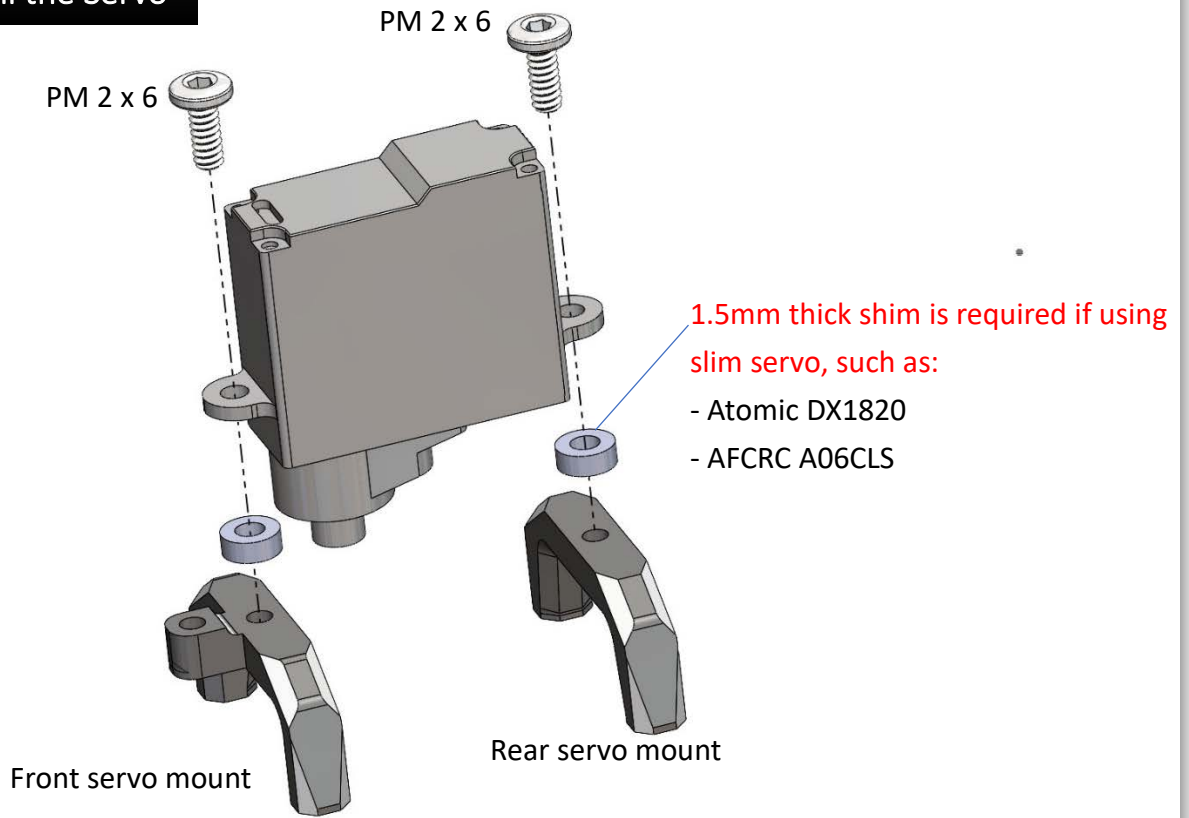

Step 02 – Steering Crank

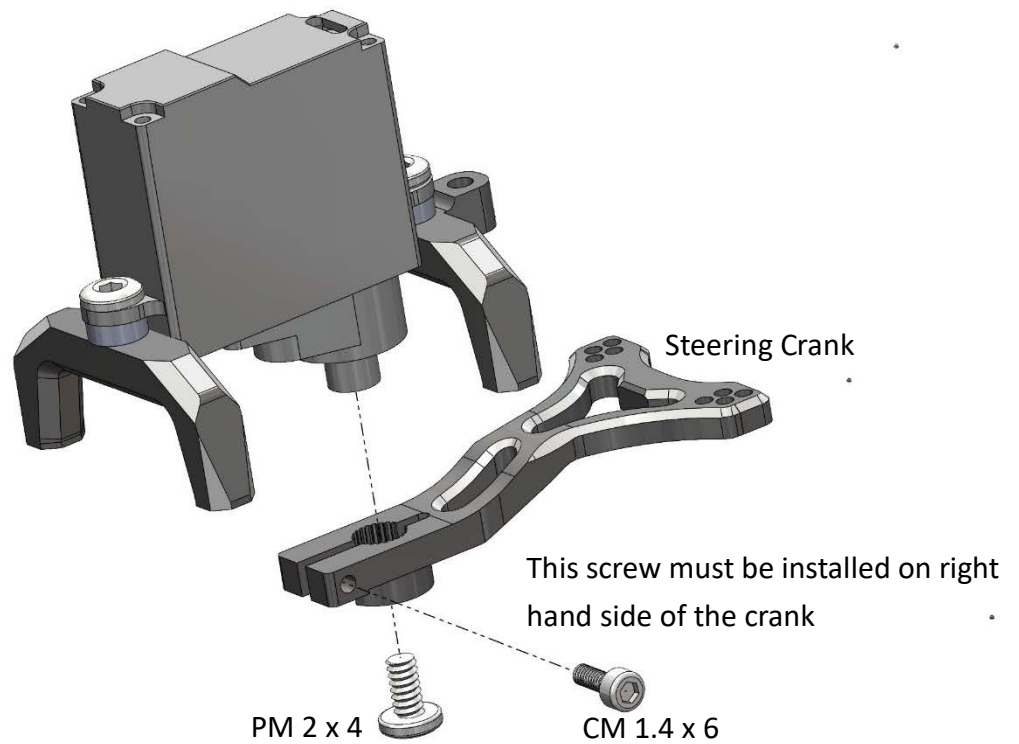

Step 03 – Ball Heads

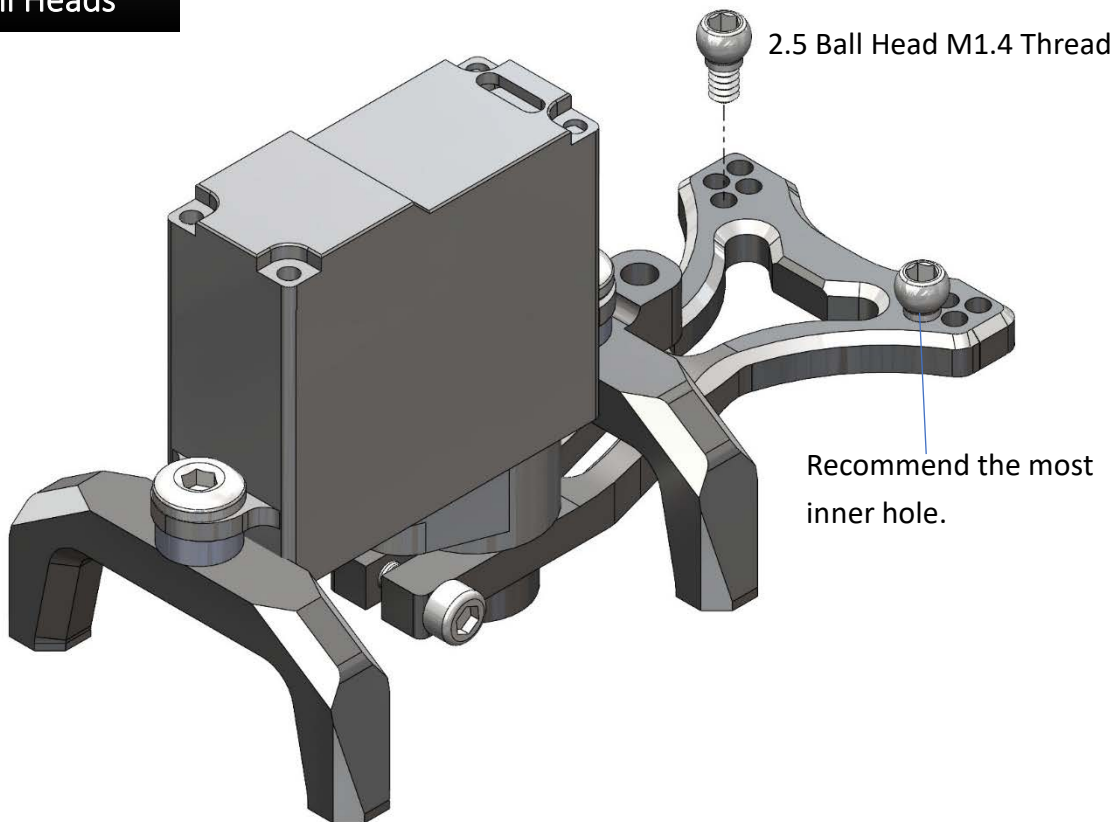

Step 04 – Linkages

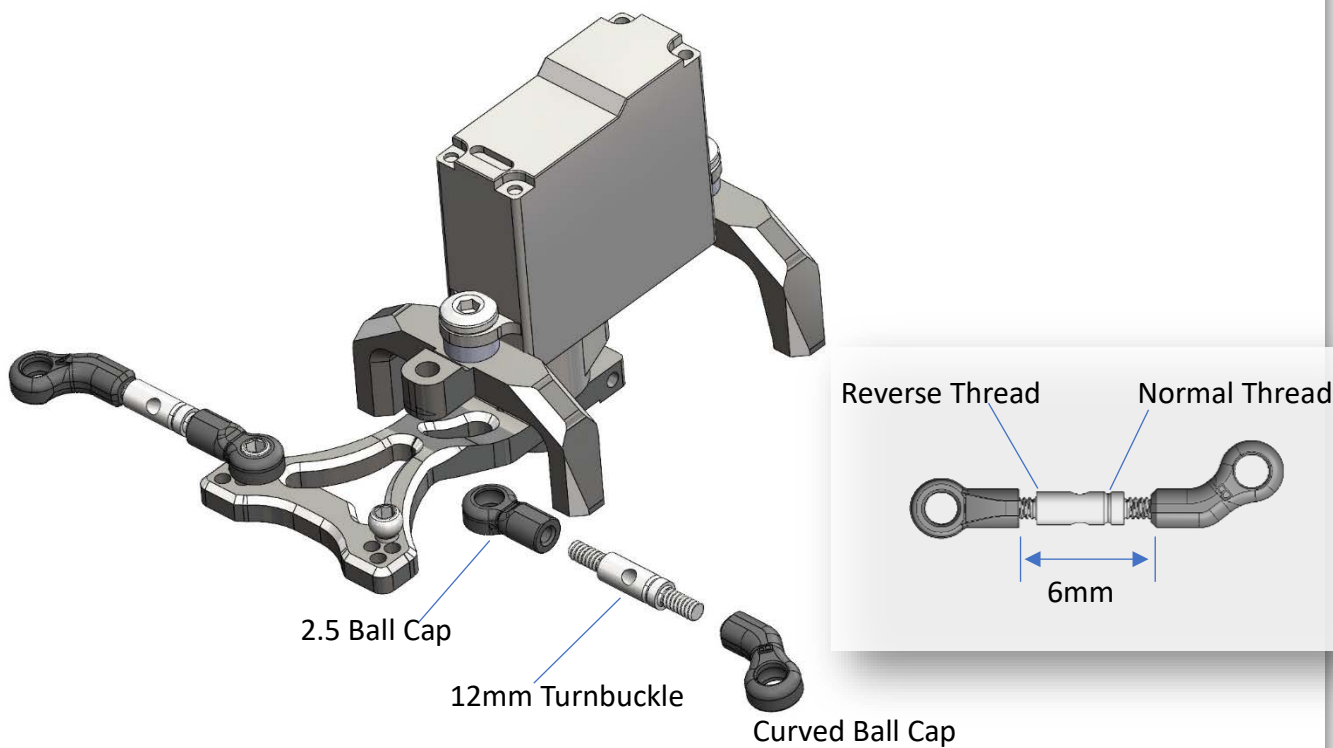

Step 05 – Support Strut

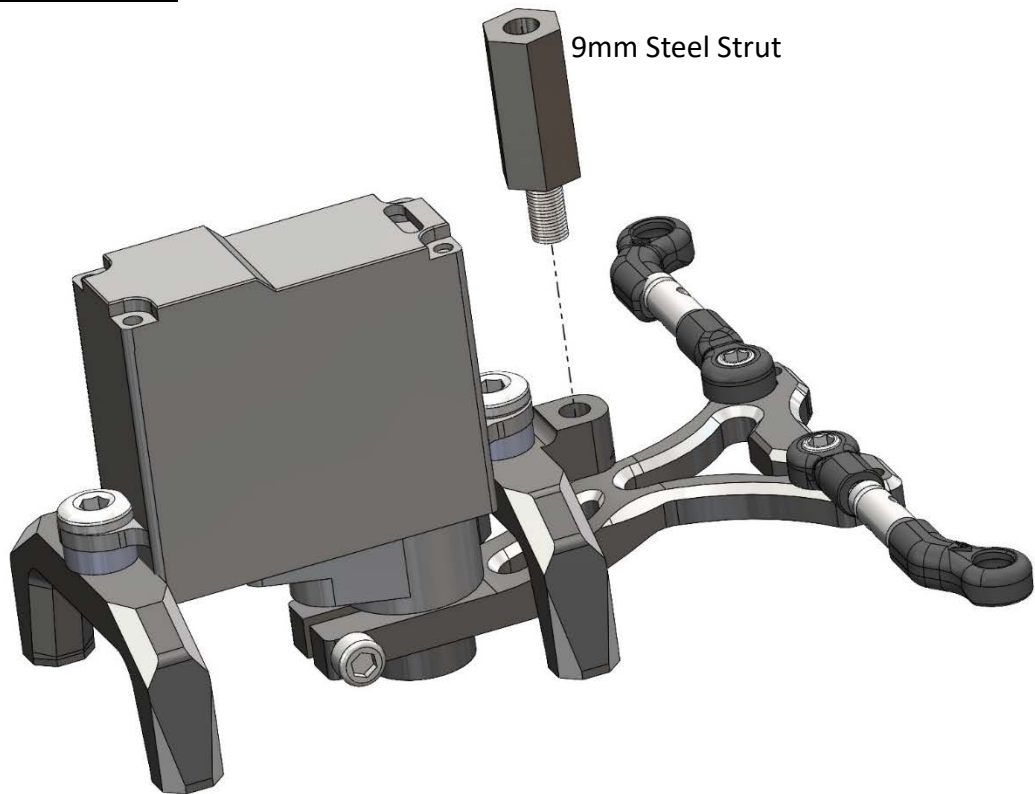

Step 06 – Install the system to the Chassis

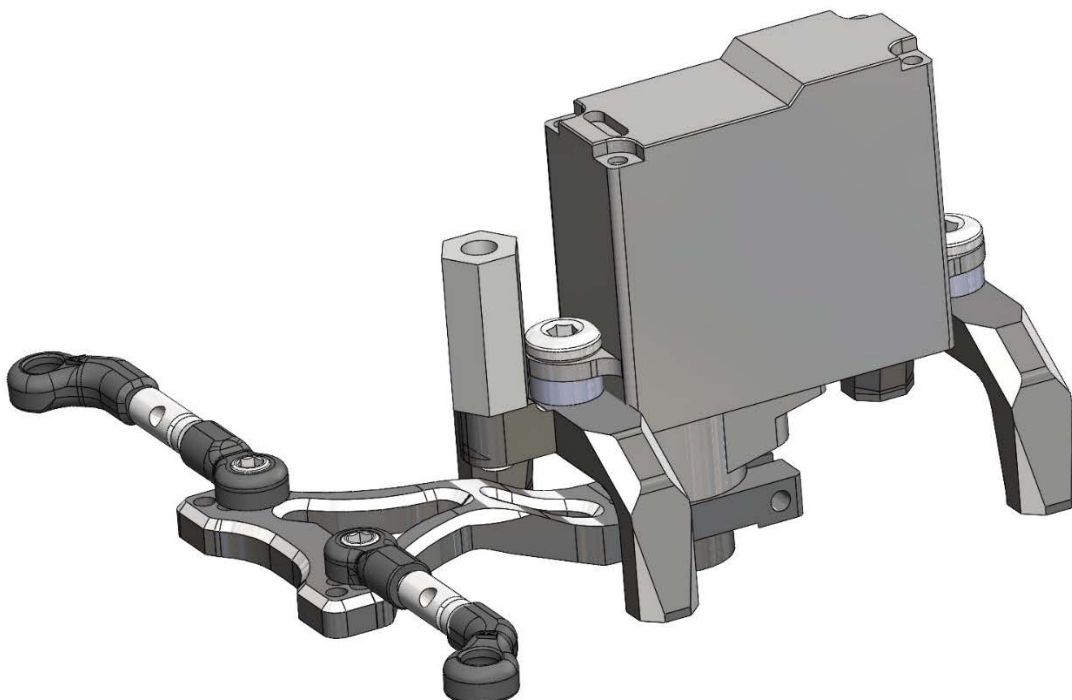

Direct Drive Steering system is ready and please install it to the car chassis

***** please Adjust the EPA of the Gyro again because now we have changed the steering**